

## REPLACEMENT PARTS LIST

RESIDENTIAL SPLIT SYSTEM AIR CONDITIONER

WSA2BF4M(1,2)SN SERIES

16 SEER MODELS



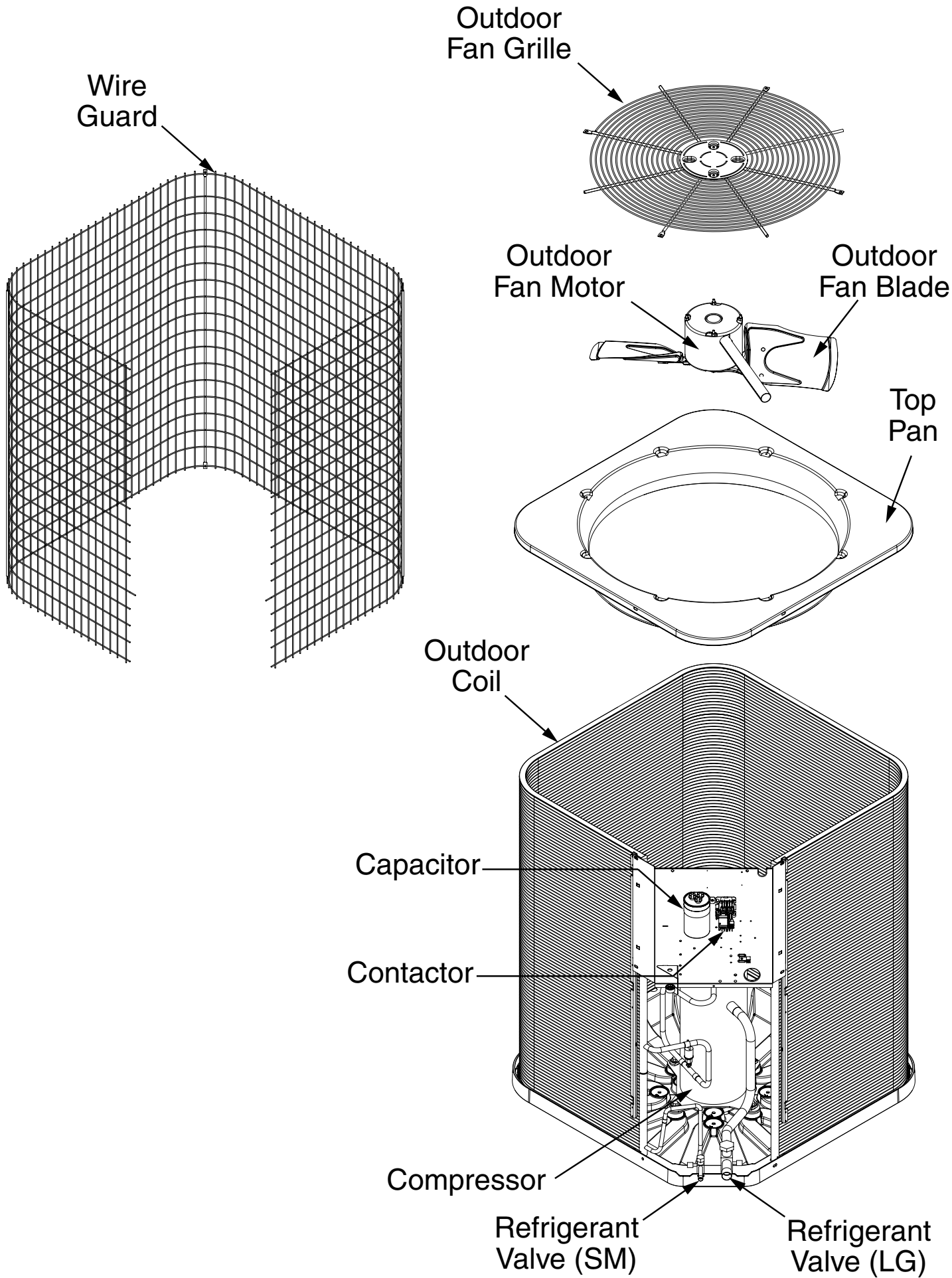

## WSA2BF4M(1,2)SN RESIDENTIAL SPLIT SYSTEM AIR CONDITIONER

DESCRIPTION	WSA2BF4M1SN24K	WSA2BF4M1SN30K	WSA2BF4M1SN36K	WSA2BF4M1SN42K	WSA2BF4M1SN48K	WSA2BF4M2SN60K
	1021699W	1021700W	1021701W	1021702W	1021703W	1021704W
CAPACITOR	01-0083	01-0084	01-0085	01-0273	01-0271	01-0097
COMPRESSOR	921422	921424	921426	1017098R	921465	921793
COMPRESSOR MOLDED PLUG	634660R	634660R	634660R	634660R	634660R	634660R
COMPRESSOR PLUG, LV 2 STAGE	—	—	—	—	—	634682R
CONTACTOR	1014863R	1014863R	1014863R	1014863R	1014865R	1014865R
CRANKCASE HEATER	—	—	—	—	—	632410R
FILTER DRIER	669764R	669764R	669764R	669764R	669764R	669764R
HAIL GUARD (FLEXIBLE MESH)	669231R	669228R	669234R	1025196R	1025196R	1025196R
HIGH PRESSURE SWITCH	632473R	632473R	632473R	632473R	632473R	632473R
LOW PRESSURE SWITCH	—	—	—	—	—	632393R
OUTDOOR COIL	1009901R	1009903R	1009904R	1009908R	1009908R	1009908R
OUTDOOR FAN BLADE	667261R	1024013R	1024013R	1024013R	667351R	667319R
OUTDOOR FAN GRILLE	669334R	669335R	669335R	669335R	669335R	669335R
OUTDOOR FAN MOTOR	621919	622171	622080	622066	1006724	1006724
REFRIGERANT VALVE (LG)	663864R	663864R	663864R	663865R	663865R	663865R
REFRIGERANT VALVE (SM)	663862R	663862R	663862R	663862R	663862R	663862R
TOP PAN	496161YR	496162YR	496162YR	496162YR	496162YR	496162YR
WIRE GUARD	102399404R	102399501R	102399504R	102399505R	102399505R	102399505R

Please specify the correct Model No., Serial No., and part number(s) when ordering parts from the nearest authorized dealer or service center.

